

- KEY:-**
- EXISTING HIGHWAY BOUNDARY
 - VISIBILITY TO PRIMARY SIGNAL - 160m SSD (DESIGN SPEED 85kph / SPEED LIMIT 50mph) IN ACCORDANCE WITH TABLE 2.10 FROM CD 109
 - VISIBILITY TO PRIMARY SIGNAL - 90m SSD (DESIGN SPEED 60kph / SPEED LIMIT 30mph) IN ACCORDANCE WITH TABLE 2.10 FROM CD 109
 - VISIBILITY TO PRIMARY SIGNAL - 43m SSD (DESIGN SPEED 60kph / SPEED LIMIT 30mph) IN ACCORDANCE WITH TABLE 7.1 FROM MANUAL FOR STREETS
 - EXISTING VISIBILITY TO GIVE WAY LINE - 90m SSD (DESIGN SPEED 60kph / SPEED LIMIT 30mph) IN ACCORDANCE WITH TABLE 2.10 FROM CD 109
 - - - JUNCTION INTERVISIBILITY ZONE
 - ⚡ TRAFFIC SIGNALS
 - ⚡ TRAFFIC SIGNALS
 - ▬ TACTILE PAVING
 - ▬ CORDUROY PAVING
 - ▬ ELECTRIC FEEDER PILLAR
 - ▬ TRAFFIC SIGNALS CABINET

- NOTES:-**
- THIS DRAWING SHOULD BE READ IN CONJUNCTION WITH ALL DRAWINGS AND CCC'S HOUSING ESTATE ROAD CONSTRUCTION SPECIFICATION CURRENTLY DATED JANUARY 2023, AS WELL AS SUBSEQUENT REVISIONS OF THIS SPECIFICATION. NB IT SHOULD BE NOTED THAT THE REVISION OF THE SPECIFICATION IS FIXED BY THE DATE OF TECHNICAL APPROVAL. THE DESIGNER WILL PROVIDE THE CONTRACTOR WITH A COPY OF THE SPECIFICATION WHICH IS CURRENT AT THE DATE OF TECHNICAL APPROVAL.
 - THE DEVELOPER WILL ENSURE THAT A COPY OF THE CAMBRIDGESHIRE COUNTY COUNCIL, HOUSING ESTATE ROAD CONSTRUCTION SPECIFICATION (REVISION DATE OF SPECIFICATION FIXED BY TECHNICAL APPROVAL) IS ON SITE AT ALL TIMES AND IS READILY AVAILABLE TO ALL GROUND WORKERS, ENGINEERS OR ANY OTHER STAFF INVOLVED IN THE MANAGEMENT, CONSTRUCTION, DETAILING OR THE LIKE IN RELATIONSHIP TO THE CONSTRUCTION OF THE PROPOSED ADOPTED PUBLIC HIGHWAY.
 - ALIGNMENT OF HIGHWAY BOUNDARY BASED ON HIGHWAY BOUNDARY INFORMATION PROVIDED BY CAMBRIDGESHIRE COUNTY COUNCIL INTERPOLATED AND ALIGNED TO PHYSICAL FEATURES ON THE TOPOGRAPHICAL SURVEY.

DESIGN RISK

STOPPING SIGHT DISTANCE (SSD) TO THE EXISTING GIVE WAY LINE ON HUMPHRIES WAY IS RESTRICTED BY THE HIGHWAY BOUNDARY (SSD = 90m BASED ON A DESIGN SPEED OF 60kph). SSD (90m) TO THE PROPOSED PRIMARY TRAFFIC SIGNAL IS AN IMPROVEMENT COMPARED TO THE EXISTING JUNCTION ARRANGEMENT BUT IS ALSO RESTRICTED BY THE HIGHWAY BOUNDARY. HOWEVER, SSD BASED ON THE MANUAL FOR STREETS DESIGN GUIDANCE IS UNRESTRICTED. THIS ISSUE IS TO BE DISCUSSED FURTHER WITH CCC.

①

THE EXISTING LAY-BY IS LOCATED WITHIN 3.75m TO THE A10 / HUMPHRIES WAY JUNCTION (V = DESIGN SPEED = 85kph, 3.75 x 85kph = 318.75m). THIS IS NOT IN ACCORDANCE WITH CLAUSE 3.7 OF CD 169. THIS IS AN EXISTING ISSUE WHICH IS TO BE DISCUSSED FURTHER WITH CCC.

②

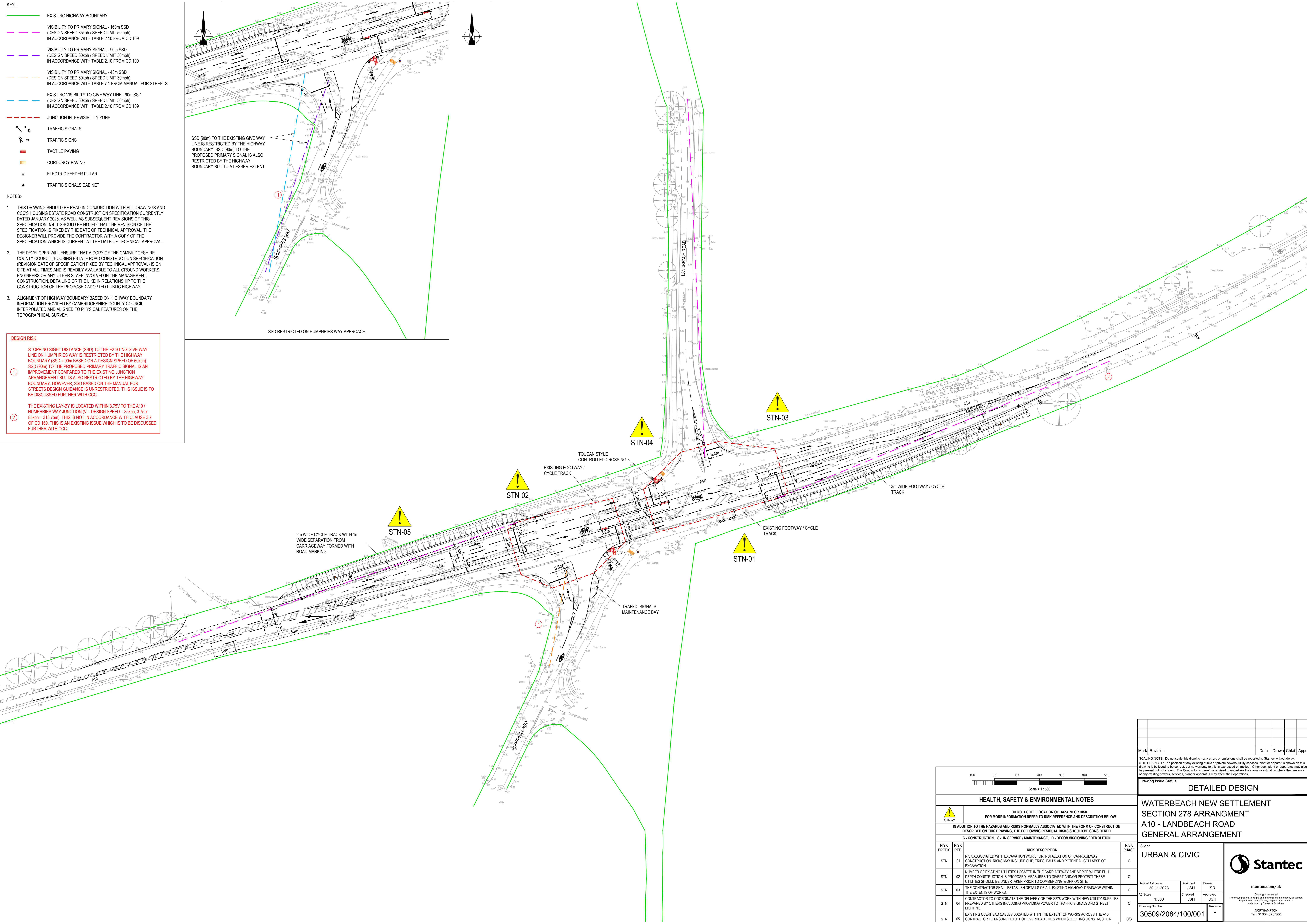
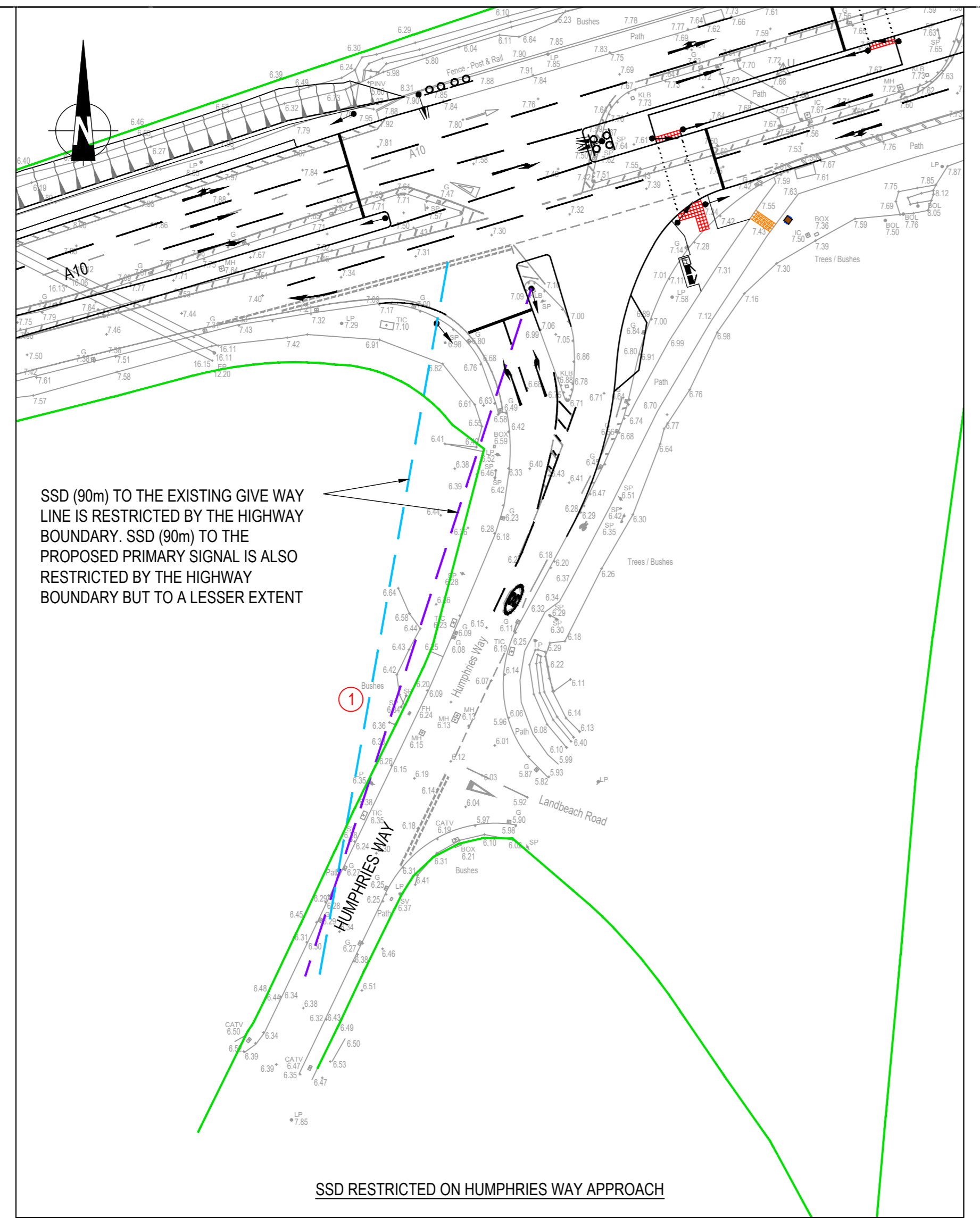

HEALTH, SAFETY & ENVIRONMENTAL NOTES

⚠ DENOTES THE LOCATION OF HAZARD OR RISK. FOR MORE INFORMATION REFER TO RISK REFERENCE AND DESCRIPTION BELOW.

IN ADDITION TO THE HAZARDS AND RISKS NORMALLY ASSOCIATED WITH THE FORM OF CONSTRUCTION DESCRIBED ON THIS DRAWING, THE FOLLOWING RESIDUAL RISKS SHOULD BE CONSIDERED

C - CONSTRUCTION, S - IN SERVICE / MAINTENANCE, D - DECOMMISSIONING / DEMOLITION

RISK PREFIX	RISK REF.	RISK DESCRIPTION	RISK PHASE
STN	01	RISK ASSOCIATED WITH EXCAVATION WORK FOR INSTALLATION OF CARRIAGEWAY CONSTRUCTION RISKS MAY INCLUDE SLIP, TRIPS, FALLS AND POTENTIAL COLLAPSE OF EXCAVATION.	C
STN	02	NUMBER OF EXISTING UTILITIES LOCATED IN THE CARRIAGEWAY AND VERGE WHERE FULL DEPTH CONSTRUCTION IS PROPOSED. MEASURES TO DIVERT AND/OR PROTECT THESE UTILITIES SHOULD BE UNDERTAKEN PRIOR TO COMMENCING WORK ON SITE.	C
STN	03	THE CONTRACTOR SHALL ESTABLISH DETAILS OF ALL EXISTING HIGHWAY DRAINAGE WITHIN THE EXTENTS OF WORKS.	C
STN	04	CONTRACTOR TO COORDINATE THE DELIVERY OF THE S278 WORK WITH NEW UTILITY SUPPLIES PREPARED BY OTHERS INCLUDING PROVIDING POWER TO TRAFFIC SIGNALS AND STREET LIGHTING.	C
STN	05	EXISTING OVERHEAD CABLES LOCATED WITHIN THE EXTENT OF WORKS ACROSS THE A10. CONTRACTOR TO ENSURE HEIGHT OF OVERHEAD LINES WHEN SELECTING CONSTRUCTION	C/S

Mark	Revision	Date	Drawn	Chkd	Appd

SCALING NOTE: Do not scale this drawing - any errors or omissions shall be reported to Stantec without delay.

UTILITIES NOTE: The position of any existing public or private sewers, utility services, plant or apparatus shown on this drawing is believed to be correct, but no warranty by this is expressed or implied. Other such plant or apparatus may also be present but not shown. The Contractor is therefore advised to undertake their own investigation where the presence of any existing sewers, services, plant or apparatus may affect their operations.

Drawing Issue Status: **DETAILED DESIGN**

WATERBEACH NEW SETTLEMENT SECTION 278 ARRANGMENT A10 - LANDBEACH ROAD GENERAL ARRANGEMENT

Client: **URBAN & CIVIC**

Date of 1st Issue: 30.11.2023

AD Scale: 1:500

Drawing Number: **30509/2084/100/001**

Revision: -

Stantec

stantec.com/uk

Copyright reserved. The copyright in all designs and drawings is the property of Stantec. Reproduction or use for any purpose other than that authorized by Stantec is strictly prohibited.

NORTHAMPTON
Tel: 01604 878 300